

Plan View

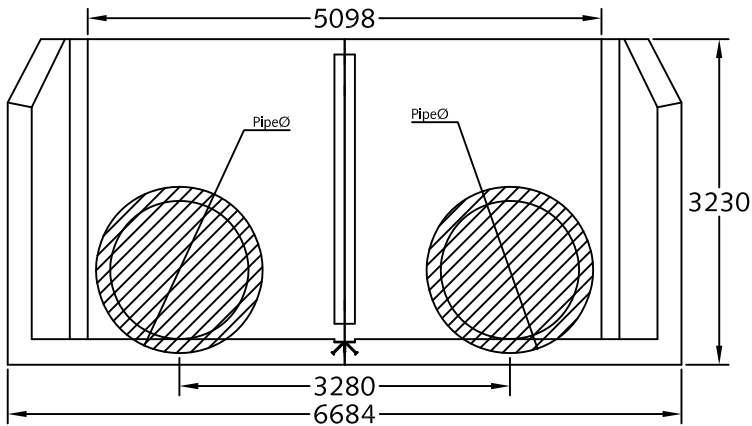

Elevation View

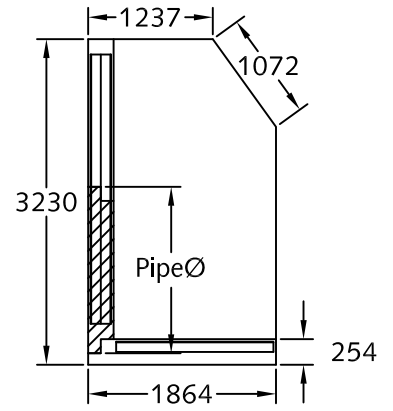

Section View

Notes:

1. HW 26-28 (Custom width) to be supplied as shown.
2. Unit to be built in two sections as shown.
3. Sections to be welded together using angle iron as shown.
4. Welding done by others on site.
5. Upon completion of the welding, section shall be grouted using non-shrink min. strength 5000 psi grout, by others.
6. Unit c/w rough core for inlet/outlet as shown.
7. lifting inserts will be provided as required.
8. Approximate weight: 9561 Kg (Each Section).
9. Minimum concrete strength: 28 Mpa.
10. All dimensions are in millimeters.



DESCRIPTION:

HW 26-28
Custom Design

www.langleyconcretegroup.com

DRAWN BY:	KS	ORIGIN:	CHWK
CHK BY:	SW/JDB	DWG NO:	HW26-28-CUS
DATE:	JAN/18/2010	REV DATE:	N/A
SCALE:	1:75		

This drawing is the property of the Langley Concrete Group of Companies. All information contained herein is confidential and may not be used in whole or in part without written permission from the owner.