

Plan View

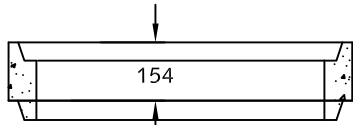

Weight: 75 kgs

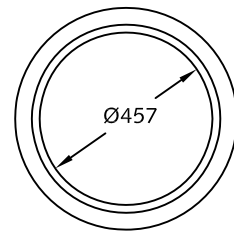
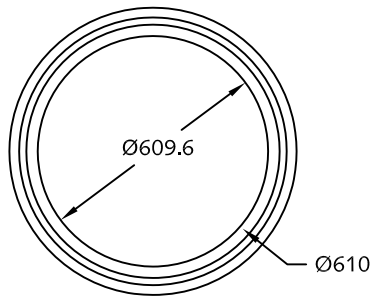
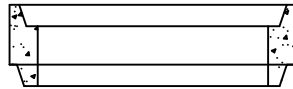

Weight: 65 kgs

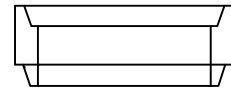

Weight: 40 kgs

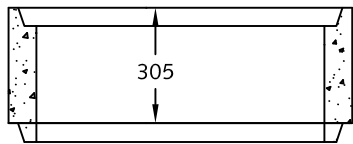

Weight: 150 kgs

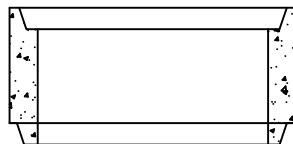

Weight: 130 kgs

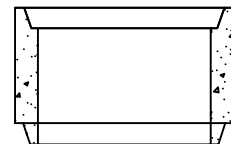

Weight: 80 kgs

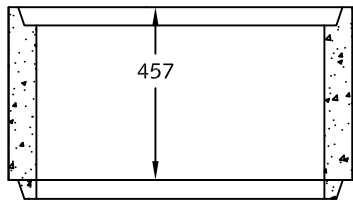

Weight: 220 kgs

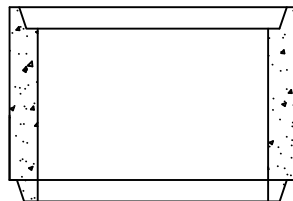

Weight: 190 kgs

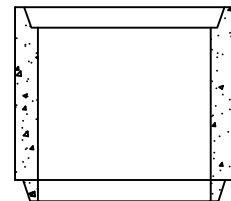

Weight: 120 kgs

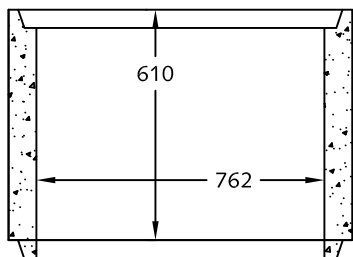

Weight: 300 kgs

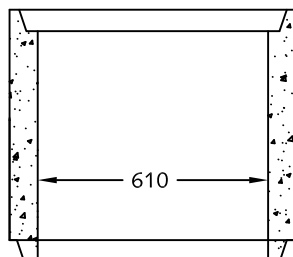

Weight: 255 kgs

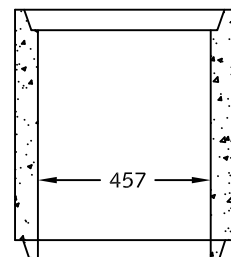

Weight: 160 kgs

Section View

Notes:

1. Standard risers available from stock for Tongue & Groove Barrels.
2. Non-Reinforced Risers manufactured to ASTM C14 specifications.
3. Reinforced Risers manufactured to ASTM C478 Specifications.
4. Tongue & Groove Joints shown are typical mortar joints.
5. Lids, cast iron grates & slotted concrete to sit flush in top / groove joint available
6. All dimensions are in millimeters..



DESCRIPTION:

Tongue & Groove Risers
Ø750 - 450

www.langleyconcretegroup.com

DRAWN BY: JAO

ORIGIN: CHWK

SCALE: 1:20

DRAWING NO:

DATE: May/05/2010

Risers

This drawing is the property of the Langley Concrete Group of Companies. All information contained herein is confidential and may not be used in whole or in part without written permission from the owner.

LANGLEY (604)533-1656

VICTORIA (250) 478-9581

CHILLIWACK 1-800-667-9600