

Plan View

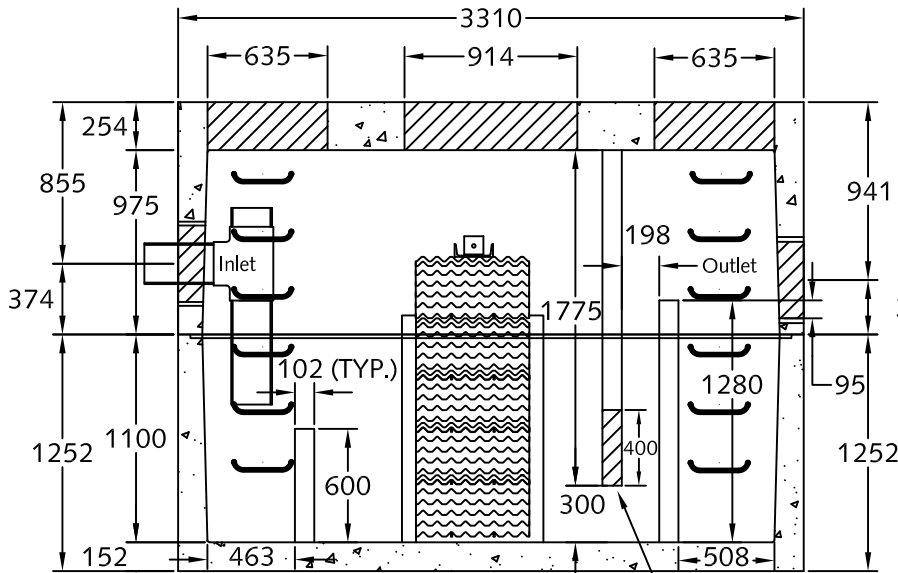

Section A-A

See section B-B for this baffle detail

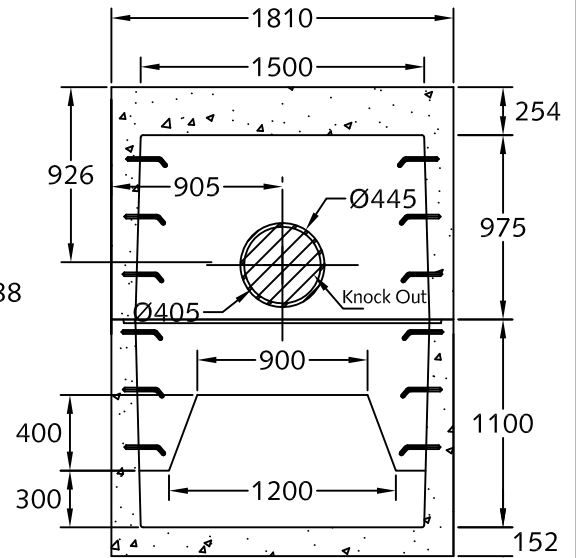

Section B-B

Notes:

1. 3152-16 mm spacing, Oil interceptor manufactured to meet AASHTO HS20 live loading.
2. Unit dimensions are 3.0 x 1.5 x 2.0 m.
3. Reinforced concrete lid manufactured for AASHTO HS20 live loading.
4. Unit c/w knockout cores for inlet/outlets as shown.
5. Unit c/w 2-Ø635, 1-Ø914 mm opening for accesses as shown.
6. Oil interceptor c/w 102 mm thick concrete baffles as shown.
7. Unit has a maximum 5,580 liter [5.58 m³] capacity.
8. Unit c/w lifting inserts as required.
9. Unit c/w ladder rungs upon request.

10. Unit design to:

- Temp.: 0°C.
- Oil S.G.: 0.85.
- Influent oil: 100 mg/l.
- Effluent oil < = 15 mg/l.
- Max. flow: 25.2 l/sec.

11. PVC required by design, installed by others in field.

12. Design can be modified for specific application, please contact LCG sales office.

13. Approximate weight:

- Top section: 7,840 kg.
- Bottom section: 7,925 kg.

14. Minimum rebar yield strength: 414 MPa.

15. Minimum concrete strength: 35 MPa.

16. All dimensions are in millimeters.



DESCRIPTION:

3152 Coalescing Plate Oil Interceptor
16 mm Spacing

www.langleyconcretegroup.com

DRAWN BY:	KS	ORIGIN:	CHWK
CHK BY:	JDB/JAO/SW	DWG NO:	3152-COI-16
DATE:	OCT/24/2008	REV DATE:	4. NOV/01/2010
SCALE:	1:40		

This drawing is the property of the Langley Concrete Group of Companies. All information contained herein is confidential and may not be used in whole or in part without written permission from the owner.