

TR18/TR20 Frame

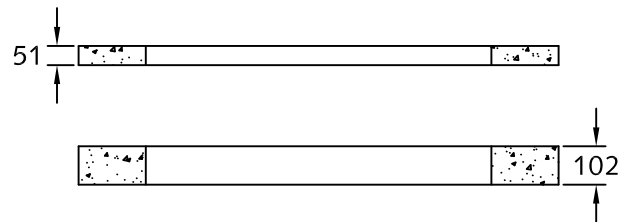

TR36/TRC1 Frame

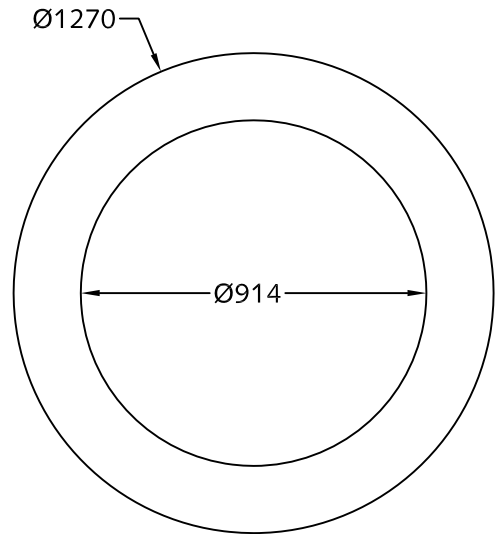
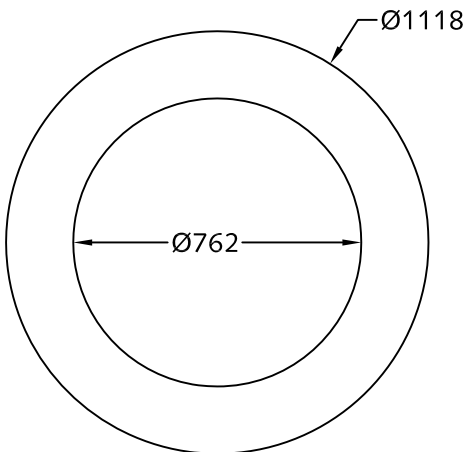

TR42 Frame

Notes:

1. All grade rings are manufactured to ASTM C 478 Specification.
2. grade rings c/w thickness as shown.
3. Riser rings are stackable.
4. Minimum concrete strength: 27.6 MPa.
5. All dimensions are in millimeters.



The LANGLEY CONCRETE Group of Companies

DESCRIPTION:

Standard Manhole
Grade Riser Rings

www.langleyconcretegroup.com

DRAWN BY: KS ORIGIN: CHWK

CHK BY: JAO/JDB/SW DWG NO: MH-SR

DATE: MAR/05/2010 REV DATE: N/A

SCALE: 1:20

This drawing is the property of the Langley Concrete Group of Companies. All information contained herein is confidential and may not be used in whole or in part without written permission from the owner.