

Section View
Design for HS20 Loadings

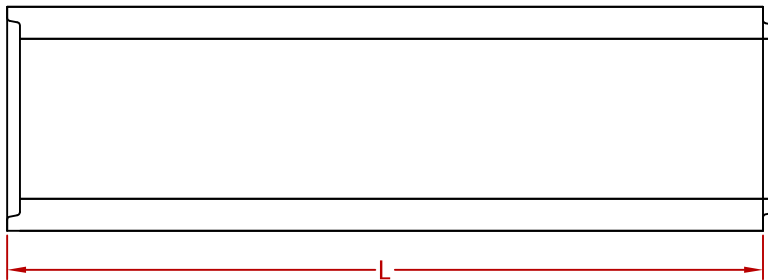

Lid Section View
Scale 1:20



Plan View

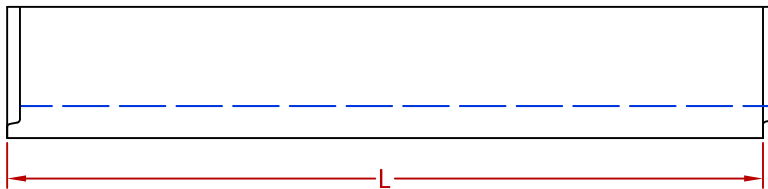

Elevation View

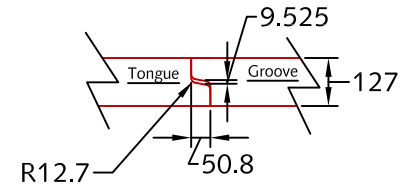

Joint Detail
Scale 1:20

Notes:

1. (L) 300-3050 x (W) 508-1200 x (H) 305-610 mm Precast Drainage Trench as shown.
2. Unit designed to withstand HS20 live loading as required.
3. Unit supplied w/ Starcon style lifting inserts as required.
4. Unit supplied with Reinforced Concrete Lid, designed to withstand HS20 live loading.
5. Minimum concrete strength: 35 MPa.
6. Welded wire mesh min. yield strength: 448 MPa.
7. Minimum rebar yield strength: 414 MPa.
8. All reinforcing to have minimum of 25.4 mm concrete cover (TYP.).
9. Approximate mass: As per size.
10. All dimensions are in millimeters.
11. Installation and Back Fill as per LCG's Trench Box Catalogue.



Quality Assurance of products manufactured by The Langley Concrete Group has been verified by the following third party certification programs:



The LANGLEY CONCRETE Group of Companies
www.langleyconcretegroup.com

DESCRIPTION:

Custom Precast Drainage Trench
Designed for HS20 Live Loading

DRAWN BY:	KS	DWG NO:PCT CUSTOM
CHK BY:	JDB/SW	REV DATE:N/A
DATE:	JUNE/17/2013	
SCALE:	1:30	
<small>This drawing is the property of the Langley Concrete Group of Companies. All information contained herein is confidential and may not be used in whole or in part without written permission from the owner.</small>		LCG Products are held to the governing ASTM, and CSA specification & tolerances.

LANGLEY (604) 533-1656 VICTORIA (250) 478-9581 CHILLIWACK 1-800 667-9600