

Plan View

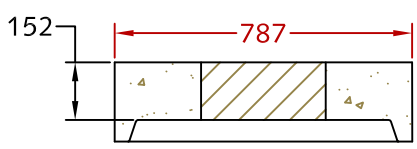

Lid Section View

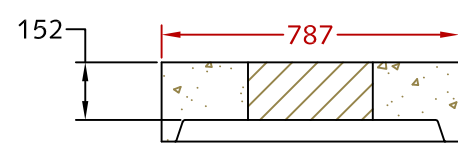

Lid Section View

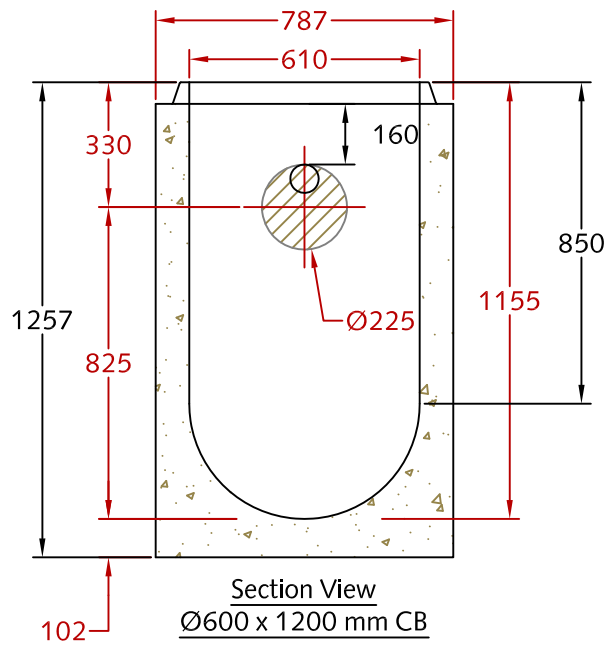

Section View  
Ø600 x 1200 mm CB

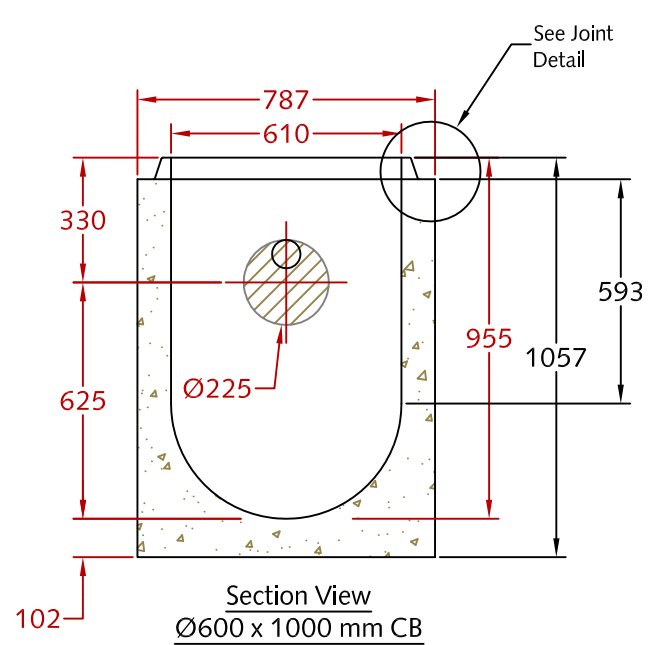

Section View  
Ø600 x 1000 mm CB

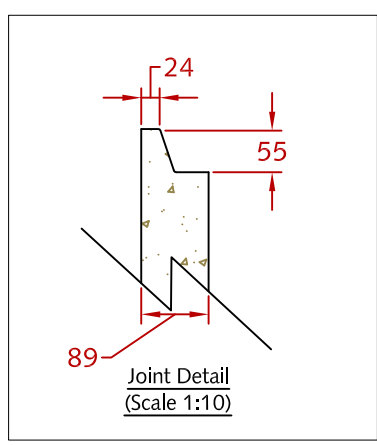

Notes:

1. Ø600 x 1200 & Ø600 x 1000 mm Catch Basins are manufactured for HS20 Traffic loading as shown.
2. Standard curb lid to fit TR23 / 24, catchbasin will accept TR26B frame & Grate.
3. Catch Basins are supplied w/ Ø225 mm core as shown. Core coles can be supplied w/ Hamilton Kent Tylox Interference-fit Flexible connectors as required.
4. Catch basins are supplied w/ 102 mm thick monolithic cast-in base as shown.
5. Trapping hood pins available on request.
6. Unit supplied w/ Starcon lifting inserts as shown.
7. Approximate mass:
  - Ø600 x 1200 mm w/ base: 755 kg.
  - Ø600 x 1000 mm w/ base: 695 kg.
8. Minimum concrete strength: 27.6 MPa.
9. All dimensions are in millimeters.
10. Langley Concrete Group is a certified Q-Cast Plant, an American Concrete Pipe Association Third Party Certification for the manufacture of Pipe, MH, Box Culvert & Precast Items.



DESCRIPTION:  
 Ø600 mm CatchBasin  
 w/ Monolithic Base  
 Standard Drawing  
 www.langleyconcretegroup.com

DRAWN BY:	KS	ORIGIN:	CHWK
CHK BY:	KO/TM	DWG NO:	CB600-3.0
DATE:	MAY/14/2013	REV DATE:	N/A
SCALE:	1:20		

This drawing is the property of the Langley Concrete Group of Companies. All information contained herein is confidential and may not be used in whole or in part without written permission from the owner.